

July 2023

## VSI 8"-10" pumps are now available on FE Select



[FE Select](#) implementation is continuing.

Franklin Electric's new selector system is now also available for E-Tech and FPS VSI 8"-10" SS Cast Submersible Pumps at 50 Hz.

Register now and start to use the new tool!

FE Select EMENA is a digital selection software tool that simplifies product selection, configuration, and quoting.

This online tool guides you through the process from start to finish, requiring only the basic application data, such as flow and head demands, to size many pumping systems. The software properly matches the components necessary for the desired application, provides specific data sheets and offers links to related informational product documentation.

### Features of FE Select:

- 24/7 accessibility
- A quick export option that allows to simplify the quotation request
- Simple software navigation

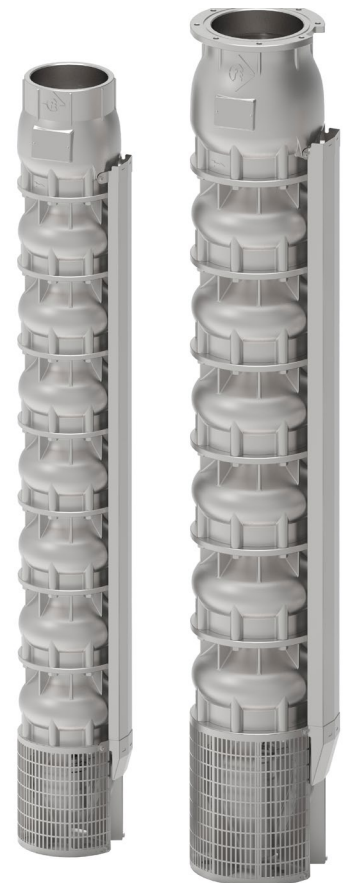

### Selection tools Franklin Electric EMENA:

More products will be added to FE Select shortly. The link will be displayed on the applicable product pages on the website [franklinwater.eu](http://franklinwater.eu). By clicking on this link, you can easily start the selection process.

In addition to FE Select, we will continue to utilize our current [Pump selector](#) software for Etech products and [High Efficiency System Selection and Payback Tool](#) until they will also be integrated into the new FE Select software at a later date. To visit our comprehensive Pump Selection page, [click here](#).

## Beyond the pumping systems

Discover more about our services and tools.

### SELECT & CONFIGURE

- FE Select (Vertical Multistage Pumps)
- Pump selector (E-Tech pumps)
- HES Selection and Payback tool

### TRAINING & EDUCATION

- On-line Training and service videos
- On-Site Training
- Customized Training

### SERVICE & SUPPORT

- On-Site Field Service
- Technical Support Team
- Mobile Apps
- Remote Service and Trouble-Shooting

For more information, please refer to our website [franklinwater.eu](http://franklinwater.eu)