

1-ABS SERIES

APPLICATIONS

The submersible pump with sump-type pick-up 1-ABS offers low on and off levels and is ideal for in-pan placement for condensate removal. An integrated, unique float switch design assures reliability and security while providing easy access to the float for servicing.

FEATURES

- Permanently lubricated motor bearings require no maintenance during life of pump
- Oil-filled motor to maximize heat dissipation
- Epoxy-coated cast aluminum pump housing
- Automatic on-off operation
- Easy to remove float housing for servicing
- Removable inlet filter screen
- 90° ¼" MNPT adapter (suitable for 12.7 mm (½") I.D. vinyl tubing)
- Low on and off level – turns on at 44.45 mm (1-¾") and off at 31.75 mm (1-¼") – will operate in most standard condensate drain pans
- Suitable for intermittent water temperature up to 49 °C
- Tank available as accessory (optional: 150102)



SPECIFICATIONS

Code	Model	HP	Input Voltage	Hz	Amps	Watts	Discharge Size	Shut-Off [m]	Bar	Cord	Weight [kg]
550531	1-ABS	1/150	230	50	0.6	70	¼" MNPT	3 (10')	0.3	3.4 m (11')	1.95 (4.31 lbs)

DIMENSIONS

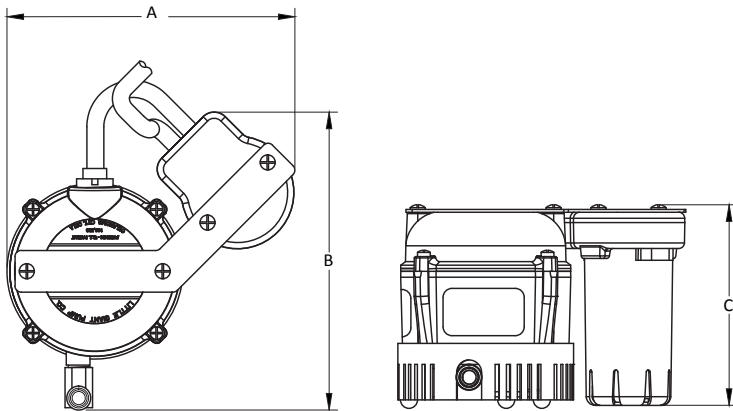

A	B	C
155 mm (6.09")	160.5 mm (6.32")	109.5 mm (4.31")

PERFORMANCE DATA

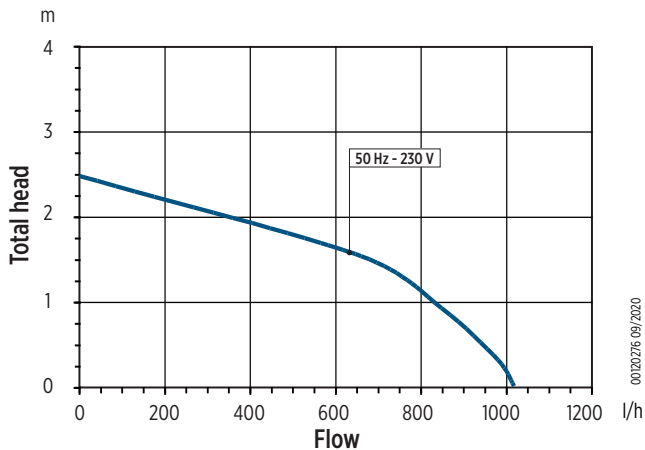

Version		Q = DELIVERY					
Input Voltage	Hz	I/h 0	200	400	600	800	1000
		US GPM 0	0.73	1.46	2.2	2.9	3.66
		H = TOTAL HEAD METRES COLUMN OF WATER [m]					
230	50	2.5	2.25	1.9	1.6	1.2	0.25

MATERIAL

Part description	Material
Motor	1/50 HP
Discharge	1/4" MNPT
Housing	Epoxy-coated cast aluminum
Cover	Epoxy-coated cast aluminum
Volute	Nylon
Impeller	Nylon
Shaft Seal	Nitrile
Screen	Polypropylene
Switch Bracket	Stainless steel
Switch	ABS

3-ABS SERIES

APPLICATIONS

Utilizing a sealed, submersible pump with collection tank, the 3-ABS is an ideal choice for a self-contained, high volume, high head condensate removal pump. An integrated, unique float switch design assures reliability and security while providing easy access to the float for servicing.



FEATURES

- 3.8 liters (1 US gallon) ABS tank
- Permanently lubricated motor bearings require no maintenance during life of pump
- Oil-filled motor to maximize heat dissipation
- Epoxy-coated cast aluminum pump housing
- Galvanized steel tank cover has 28.5 mm (1-1/8") inlet opening
- Automatic operation: On level – 114.3 mm (4.5") / Off Level – 88.9 mm (3.5")
- Easy to remove float housing for servicing
- Removable inlet filter screen
- 12.7 mm (1/2") MNPT pump discharge with brass check valve and compression fitting for 12.7 mm (1/2") OD copper or rigid plastic tubing
- 1/2 HP pump motor

SPECIFICATIONS

Code	Model	HP	Input Voltage	Hz	Amps	Watts	Discharge Size	Shut-Off [m]	Bar	Cord	Weight [kg]
551370	3-ABS	1/2	230	50	1.8	210	1/2" MNPT	7.9 (26')	0.8	2.7 m(9')	5.44 (12 lbs)

DIMENSIONS

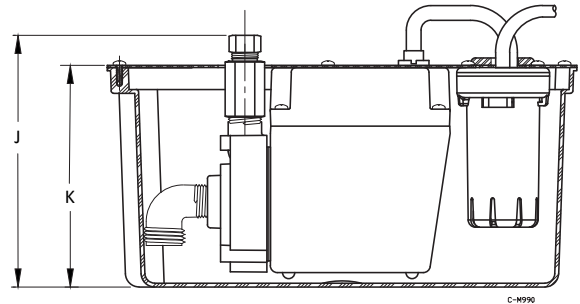
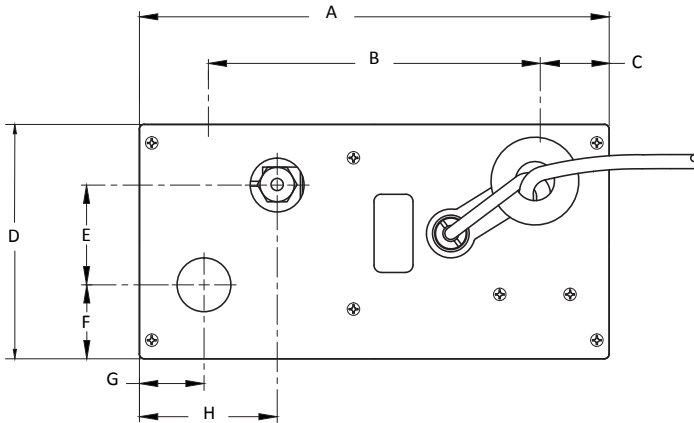

C-10990

A	B	C	D	E	F	G	H	J	K
306 mm (12.03")	216 mm (8.5")	45 mm (1.77)	153 mm (6")	65 mm (2.55")	48 mm (1.89")	42 mm (1.66")	90 mm (3.53")	165 mm (6.5")	144 mm (5.68")

PERFORMANCE DATA

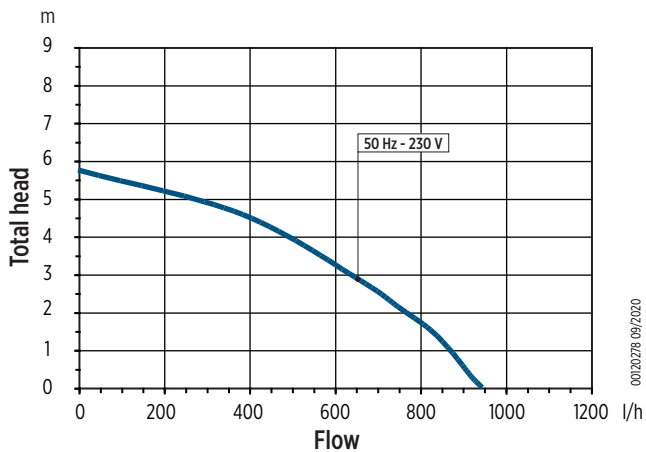

Version		Q = DELIVERY					
Input Voltage	Hz	l/h 0	200	400	600	800	1000
		US GPM 0	0.73	1.46	2.2	2.9	3.66
H = TOTAL HEAD METRES COLUMN OF WATER [m]							
230	50	5.75	5.2	4.5	3.3	1.75	-

MATERIAL

Part description	Material
Motor	½ HP
Intake	1-¼" diameter
Discharge	½" MNPT
Pump Housing/Cover	Epoxy-coated cast aluminum
Tank Cover	Galvanized steel
Volute	Nylon
Impeller	Nylon
Shaft Seal	Nitrile
Screen	Polyethylene