

# EC-1 SERIES



## APPLICATIONS

- The EC-1 model is designed to accommodate multiple electrical requirements within one pump.
- The EC-1 Series is a new concept for mini pumps incorporating an improved noise reducing design and reliable solid-state switching technology. Easy to install brackets provide a quick and precise method to accurately position and secure both parts of the pump quickly. The two-piece design allows the reservoir to be placed within the air handler while the pump-controller is located outside the air handler. The two components are connected via a convenient communications wire and suction tubing.
- EC-1 is designed for use in removing condensate from wall mount, ductless mini-split air conditioners up to 34,000 Btu. It can also be used to remove condensate from fan coils and suspended ceiling air conditioners. The pump can be installed above the air conditioner in a false ceiling, behind the wall mount air handler, or in plastic conduit or line-set channel. The reservoir, featuring a clear tank, connects to the condensate drain hose and must be positioned flat and horizontal while the pump can be oriented in any position within 1 m.



## FEATURES

### Pump - Controller

- Normally-closed relay rated at 8 A resistive - 250 V alarm
- 21 dB(A)\*
- ¼" I.D. pump discharge outlet
- Elastomeric mounting grommets on pump housing bracket
- Elastomeric passive vibration isolator used to dampen pump vibration
- Separate wall bracket for pump and reservoir included
- Thermal protection: 80 °C
- 1.5 m (60") power cable
- 10 m (3.3') communications cable (pump to reservoir)
- Ambient temperature range: 0 °C - 60 °C
- Maximum water temperature: 60 °C
- 2-year warranty

### Reservoir

- Clear reservoir for instant visual inspection of water level, float, and filter
- Hall effect on/off level sensors with high-water sensor feature
- Extra-large filter screen for longer intervals between cleaning
- Multi-step drain hose adapter (½", ⅝", and ¾")
- Simple to open reservoir for easy maintenance

## SPECIFICATIONS

Code	Model	Input Voltage	Hz	Amps	Watts	Discharge Size	Shut-Off [m]	Suction Lift	Bar	Cord	Weight [kg]
553502	EC-1	230	50	0.18	18	¼"	10 m (33")	0.91 m (3')	1.8	1.5 m (4.9")	0.77 (1.7 lbs)
553507 *	EC-1-DV *	110-240	50	0.18	18	¼"	10 m (33")	0.91 m (3')	1.8	1.5 m (4.9")	0.77 (1.7 lbs)

\* DV MODEL: The DV suffix indicates that the pump is capable of operating from a wide range of supply voltage to maintain consistent pump performance. This version hasn't EC Declaration.

## DIMENSIONS AND PARTS

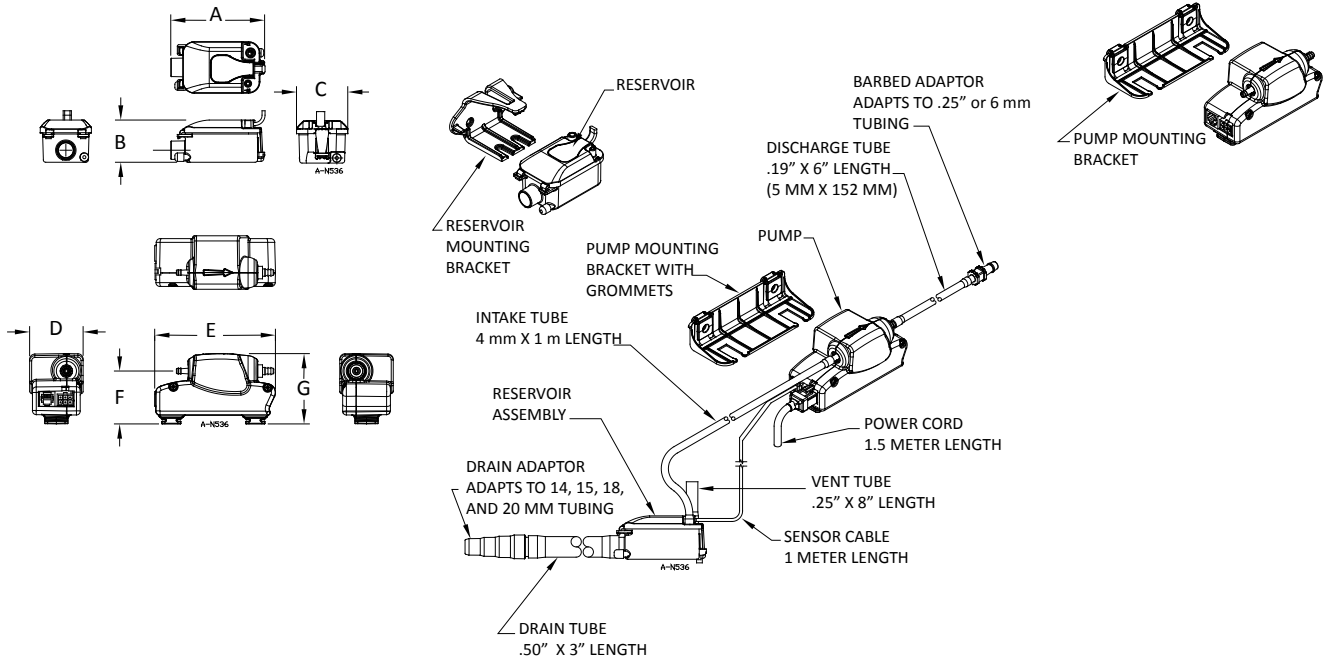

A	B	C	D	E	F	G
81.15 mm (3.20")	36.51 mm (1.44")	44.29 mm (1.74")	46.23 mm (1.82")	104.40 mm (4.11")	45.67 mm (1.80")	60.74 mm (2.39")

## PERFORMANCE DATA

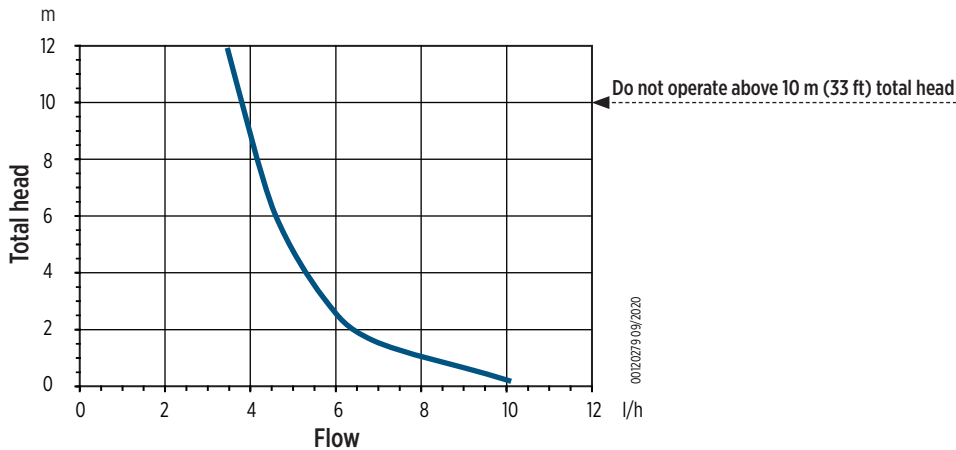

Version		Q = DELIVERY				
Input Voltage	Hz	l/h 0	4	6	8	10
		US GPM 0	0.02	0.03	0.04	0.05
H = TOTAL HEAD METRES COLUMN OF WATER [m]						
230	50	-	9	2.5	1	0.2
110-240**	50	-	9	2.5	1	0.2

\* Tested under conditions assumed consistent with competitors' published sound ratings.

\*\* DV MODEL: This version hasn't EC Declaration

# EC-1K SERIES



## APPLICATIONS

- The EC-1K model is designed to accommodate multiple electrical requirements within one pump.
- EC-1K Line Set Duct provides space to install the EC-1, line-set pipes, electrical wiring and drain hoses providing a clean, finished look in any décor. The pump is easily accessible for maintenance or cleaning by removing the cover (no tools required). When using the EC-1K Line Set Duct, the EC-1 pump is always properly positioned to maximize the quiet operation of the pump and keep the reservoir level for ideal operating performance.

## FEATURES

- **Includes EC-1 Mini Condensate Pump**
- 21 dB(A)\*
- 10 l/h (2.7 gph) flow
- 10 m (33 ft) shut off (max. recommended)
- Hall effect switching
- Inlet filter dedicated
- Multi-size hose drain adapter fits all popular drain hose connections
- 2-year warranty

### Line Set Kit

- Right- or left-side installation options
- 5.3 cm x 7.6 cm (2.1" x 3.0") Line Set Duct inside dimension
- 50 cm (19.7") drain hose tubing
- Detachable power cord 213.4 cm (84")
- 90° "elbow" for locating pump reservoir
- 80 cm (31.5") straight line set cover
- Room inside Line Set Duct for 3/8" and 5/8" line set pipe
- Twist motion snap-lock clips and cable ties to secure the line set
- Pump enclosure and pump mounting bracket
- Wall fasteners included (to secure Line Set Duct to wall)
- Air conditioner trim and bracket for "finished" look



## SPECIFICATIONS

Code	Model	Input Voltage	Hz	Amps	Watts	Discharge Size	Shut-Off [m]	Suction Lift	Bar	Cord	Weight [kg]	Dimensions (H x L x W [cm])
553512	EC-1K	110-240	50	0.18	18	1/4"	10 m (33")	0.91 m (3')	1.8	1.5 m (4.9")	0.77 (1.7 lbs)	10.4 x 4.6 x 6.1 (4.1" x 1.8" x 2.4")
553517 *	EC-1K-DV *	110-240	50	0.18	18	1/4"	10 m (33")	0.91 m (3')	1.8	1.5 m (4.9")	0.77 (1.7 lbs)	10.4 x 4.6 x 6.1 (4.1" x 1.8" x 2.4")

\* DV MODEL: The DV suffix indicates that the pump is capable of operating from a wide range of supply voltage to maintain consistent pump performance. This version hasn't EC Declaration.

## PARTS

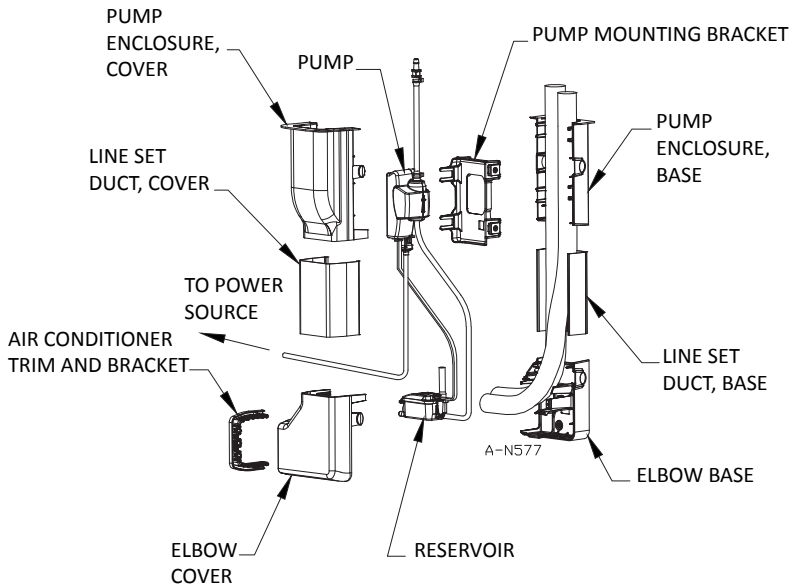

## PERFORMANCE DATA

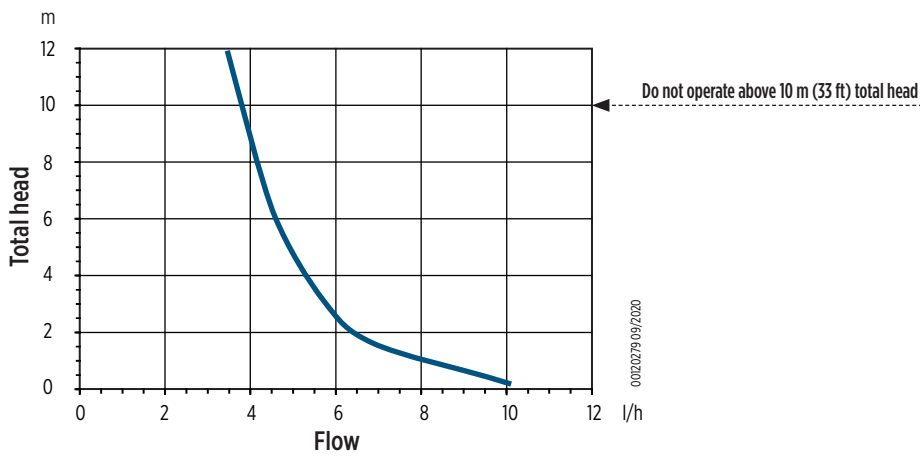

Version		Q = DELIVERY				
Input Voltage	Hz	l/h 0	4	6	8	10
		US GPM 0	0.02	0.03	0.04	0.05
H = TOTAL HEAD METRES COLUMN OF WATER [m]						
230	50	-	9	2.5	1	0.2
110-240**	50	-	9	2.5	1	0.2

\* Tested under conditions assumed consistent with competitors' published sound ratings.

\*\* DV MODEL: This version hasn't EC Declaration